

HDMI-Stick Miracast/WiFi Direct/DLNA MMS-894.mira



User Manual

INHALT

Important Safety Precautions	5
Product features.....	6
Package content.....	7
Product overview.....	8
Konformitätserklärung.....	9
Preparations before Use	10
Connection.....	11
What is DLNA, Miracast , AllShare Cast?.	12
Usage Summary	12

Using the device	13	Specifications	29
Powering up.....	13		
Network Setup	13		
Bridge to wireless Mode	14		
Virtual AP only Mode	16		
System Setup.....	16		
Switch Mode	18		
DLNA mode/Android devices	19		
DLNA mode/Windows7 above	20		
DLNA mode/iOS devices.....	22		
Miracast mode.....	24		
		GNU GENERAL PUBLIC LICENSE	30
Appendix	26		
Compatible devices list	26		
Usage Cases	27		

All brand names and trademarks are properties of their Respective owners.



IMPORTANT SAFETY PRECAUTIONS

- Please read the instruction manual before you use the product.
- Please follow all instructions.
- To avoid any risk of electric shock or other injury, never disassemble or reassemble this product.
- To avoid any risk of fire, electric shock or device failure, never use this product in humid environments.
- Never use this product at the temperature higher than 35°C (95°F) or lower than 5°C (41°F).
- Never block the ventilation holes.
- To avoid placing this product near heating equipment, strong magnetic field, violent shaking environment or under direct sun exposure.
- Keep the product away from any metal or liquid to avoid short circuit or risk of fire.
- Never overbend, step on or clip the cable.
- Never overload the plug socket.
- Only clean the product with a dry cloth.
- Only use the accessories recommended by the manufacturer.
- Unplug the product from the power (Micro USB-port) if it's not used for a

long time or while thunderstorms are approaching.

PRODUCT FEATURES

- With the innovation of Wi-Fi Display Dongle and easy application of the free APP, you can easily share photo, music and video from your smartphone, tablet and computer to HDTV, monitor or projector with HDMI port. You can enjoy streaming High Definition multimedia content quickly and reliably to share with your family and friends.
- In addition, if your smartphone, tablet and computer supports Wi-Fi CERTIFIED Miracast, you can mirror the screen of your device to a TV, monitor or projector by Miracast.
- In the meantime, you can also surf the web easily while playing multimedia content via Wi-Fi-based internet. You would never miss any online-message from friends when you share times with your family. With the free APP of iMediaShare, you can even share web video from Facebook, Picasa or YouTube with your friends and family on a larger display.

Package content

1. Wi-Fi Display Dongle
2. Micro USB cable
3. Instruction manual

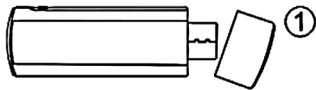

Product overview

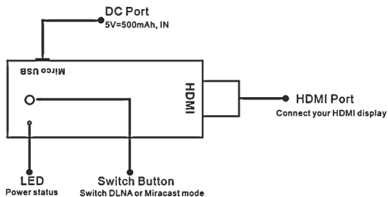

- Switch button: 2 modes are switched in cycle by short-pressing the button. The factory default setting is "DLNA mode". It's followed by "MIRACAST mode". Short-pressing the button once will change to MIRACAST mode.
- DC Port: For powering the device via USB cable, 5V=500mAh is required.
- HDMI Port: For connection to TV, projector and HDMI-compatible display.
- LED indicator: Shows the power status.

Konformitätserklärung

Hiermit erklärt PEARL.GmbH, dass sich das Produkt PX-1434 in Übereinstimmung mit der R&TTE-Richtlinie 99/5/EG und der RoHS-Richtlinie 2011/65/EU befindet.

PEARL.GmbH, PEARL-Str. 1-3, 79426 Buggingen, Deutschland



Leiter Qualitätswesen
Dipl. Ing. (FH) Andreas Kurtasz
30.01.2014

Die ausführliche Konformitätserklärung finden Sie unter www.pearl.de. Klicken Sie unten auf den Link **Support (Handbücher, FAQs, Treiber & Co.)**. Geben Sie anschließend im Suchfeld die Artikelnummer PX-1434 ein.

PREPARATIONS BEFORE USE

Before you use the Wi-Fi Display Dongle, please make sure below devices are ready.

1. To apply with a smartphone, tablet or computer, your hardware must support the wireless network 802.11b/g/n - standard. For PC-computers, the OS must be Windows 7 or above.

2. Wi-Fi Router



Note:

- a. *Please use Wi-Fi router which capably supports 802.11b/g/n and 300Mbps above for better connection.*
- b. *To make sure your smartphone, tablet, computer and Wi-Fi Display Dongle are closer enough to the Wi-Fi router. Please try to avoid areas that have a lot of noise or interruption from surrounding wireless signals.*

3. Micro USB - Cable
4. TV, monitor or projector must be equipped with HDMI-port(s).
5. If your TV, monitor or projector does not support USB device, please prepare a 5V 500mAh AC adaptor with USB port for power supply.

Connection

1. Plug Wi-Fi Display dongle into the HDMI port of TV, monitor or projector. We suggest using the HDMI cable for better performance.
2. Power connection: Take out the Micro USB cable, plug the Micro USB connector into Wi-Fi Display Dongle, then plug the USB connector to the USB port of TV, monitor or projector. If not, plug into the AC adaptor.
3. Select correct HDMI input from the TV, monitor or projector
4. The screen will show a video and then enter to the main page

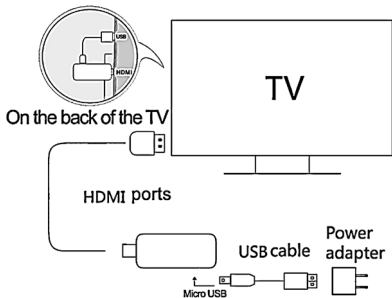
**NOTE:**

Please parallel-plug the Wi-Fi Display Dongle into the TV, monitor or projector. Vertical direction of Wi-Fi Display Dongle to the TV, monitor or projector will lead to shielding effect and cause the poor Wi-Fi signal and connection.

What is DLNA, Miracast , AllShare Cast?

TECHNOLOGY	FUNCTION
DLNA	Stream audio,video,photos to HDTV
All Share play	Stream audio,video,photos to HDTV, for Samsung Galaxy
Miracast	Mirror the screen content and audio to HDTV

All Share cast	Mirror the screen content and audio to HDTV, for Samsung Galaxy
----------------	---

Usage Summary

OS	USAGE
Android 4.2 below	Install "iMediaShare" to achieve DLNA function; or other 3rd-part support DLNA APP, such as "Skifta", "Youtube".
Android 4.2 above	Install "iMediaShare" to achieve DLNA function; or other 3rd-part support DLNA APP, such as "Youtube". Android 4.2 original support Miracast function
Samsung Galaxy	No need additional APP, build in "AllShare" and "AllShare cast"

iOS	Install 3rd-part support DLNA APP to achieve DLNA function. Such as "iMediaShare", "Youtube".
Windows7 above	Use "Windows Media Player " or "Allshare" to achieve DLNA function.
Linux	Use "uShare " to achieve DLNA function.

USING THE DEVICE

Powering up

When powering up all devices, wait a few seconds for your TV to detect the Wi-Fi Display Dongle. If it is not detected, you may need to change the input source on your TV

to HDMI. Check the user documentation of your TV for more information.

Once the Wi-Fi Display Dongle is detected, the splash screen displays the system-bootup, then the main page will be displayed on the screen. The setup is ready to use.

Network Setup

You could configurate the settings for communication, such as Network Name (SSID) and key word.

There are 2 modes of connection:

1. **Bridge to wireless Mode (Recommend):** Connect the Wi-Fi Display Dongle to Router with Wi-Fi. When you

stream the multimedia content, you can also receive other information from internet. With the free APP of iMediaShare, you can even share web videos from Facebook, Picasa or YouTube with your friends and family on a larger display.

2. **Virtual AP only Mode (Factory default setting):** To bring multimedia content from your smartphone, tablet and computer to the TV-screen, monitor or projector without home network.



NOTE:

Any change of Setup will cause the disconnection from the Wi-Fi-net-

work and a restart. Please re-connect the Wi-Fi and proceed with setup and playback.

Bridge to wireless Mode

One way for setup: Web browser (this is a quick setup).

1. Open the "WLAN"-setting of your smartphone (tablet or computer) and find Wi-Fi Display dongle's SSID (MMS-894.mira) to connect it. (Password: 12345678)



2. After the smartphone (tablet or computer) connects to MMS-894.mira WLAN successfully, open a web browser and input the Setup address on the screen.



3. Click the  icon to enter the Setup page, click "Scan", and choose the router to connect (input the password and hit the "connect"-key.)



4. The Wi-Fi Display Dongle will quit and restart. The setup is finished.
3. Enter the IP address on the screen (example: "192.168.49.1" or "192.168.1.XX")

Virtual AP only Mode

Open the WLAN-list of your smartphone (tablet or computer) and find MMS-894.mira to connect it. (Password: 12345678). Now you are ready to use it in "Virtual AP only"-Mode.

System Setup

1. Open WLAN of your devices and choose the correct Wi-Fi to connect it
2. After successful connection, open a web browser and





Switch-button icon:
Click to switch mode between Miracast and DLNA.



Media Control button:
Click the icon to show media control panel.

Switch Mode

Miracast and DLNA are working on the different WiFi working-modes. There are two methods to do the switching:

1. Via switch button on the housing.
(Please reference above [Product overview]);
2. In the web browser:
 - a. Open web browser and input the IP address on the TV screen (example: "192.168.49.1" or "192.168.1.XX").
 - b. Touch the  icon and the switching will be processed. Notice that the web browser would show some error-notice when switching. The reason is: The Wi-Fi driver should be

loaded again when switching to a new mode. So the connection between devices and WiFi-Display dongle is disconnected.



NOTE:

When your devices Wi-Fi-connect to a Wi-Fi Display dongle's SSID (MMS-894.mira), please type in the "Local IP0: 192.168.49.1" to web browser. If the device is connected to home router's SSID, then enter the "Local IP1: 192.168.XX.XX". When you use the device in Miracast mode, please pay attention to use the

IP address shown on the TV screen, which is not same as in the DLNA mode .

DLNA mode/Android devices

1. After the Android devices connect to router WLAN successfully, please download from "Play Store" by searching "iMediaShare".
2. On iMediaShare Lite program interface open a media folder, such as My Photos, My Music, My Videos, click on the media files that you want to show, then it will pops up a „playback devices“ list(as shown below), in the drop-down list find the Wi-Fi Display Dongle's

name (MMS-894.mira) and click on the name to enter the remote playback.

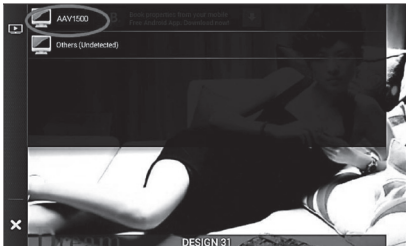

If your online video-player has a DLNA function, you can stream the online video to display device. Choose the online video, click the "DLNA"-button on the player, and

choose "MMS-894.mira" to push-send the online video:



DLNA mode/Windows7 above

1. Open the Windows Media Player. From the Player's library, click 'Stream' and choose the option 'Turn on media streaming with HomeGroup...'. (Turn on media streaming-> Verify the device(s) to which you would like to share media, if they are set to "Allowed")

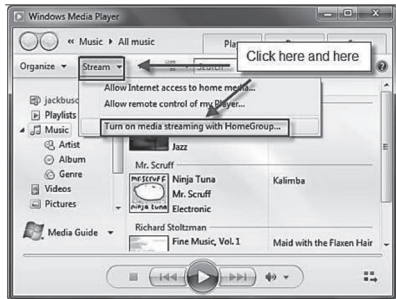

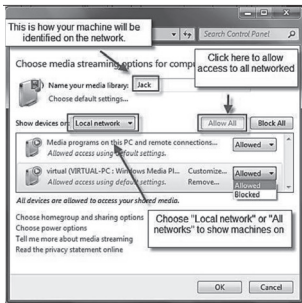

2. Select your audio video music, right click-> "Play to"-> MMS-894.mira



NOTE:

Windows Media Player 12 library requires Windows 7 or above. If you are using a third-party firewall or security software, you may have to configure it to allow the DLNA server access to your network. You also can install "AllShare" to achieve the similar function.

DLNA mode/iOS devices

1. After the iOS device has connected to your WLAN-router successfully, please download the app "iMediaShare" from "App Store". Use the "search"-function to find it.



2. On iMediaShare Lite program interface open a media folder, such as My Photos, My Music, My Videos, click on the media files that you want to show, then it will pop up a „playback devices“ list(as shown below), in the drop-down list find the WiFi Display Dongle's name (MMS-894.mira) and click on the name to enter the remote playback.

**NOTE:**

Online-video-streams have the same properties/settings like Android devices (DLNA mode).

Miracast mode

In this mode, the screens of smartphones, tablets can be mirrored to TV, monitor and projector in real time. Smartphone Apps are being displayed on the TV.

The factory default setting is “DLNA mode”, press the Wi-Fi Display Dongle’s Switch button on the housing to access the Miracast mode.

The following interface will be displayed on your screen. It is ready for use.

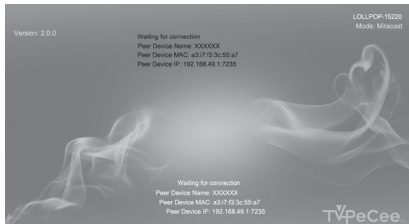

Make sure your Android device is above version 4.2 and has a WiFi Display-function.

1. Enter the settings and open WLAN of your smartphone (tablet) and find MMS-894.mira to connect it. (Password: 12345678)

2. Click to open WiFi display (Some devices call "WLAN Display", "Wireless Display"), search the device as below pictures.



Click and connect the “MMS-894.mira:XX-:XX:XX:XX:XX”, then your device will be mirrored to the large screen.

APPENDIX

Compatible devices list

The following devices are compatible with the WiFi Display Dongle and have been fully tested:

Vendor	Model
LG	Nexus4
Samsung	Galaxy S3, Galaxy S4, Note2
Sony	Xperia Z
XiaoMi	Mi2, Mi2S
Oppo	Find5
Gionee	GN708W
ZTE	Nubia Z5 NX501
AMOI	N828
HTC	NEWONE

Usage Cases

Samsung Galaxy S3, Galaxy S4, Note2

Setting -> Turn on "Wi-Fi" -> More settings -> Turn on "AllShare Cast" -> "MMS-894.mira:XX:XX-:XX:XX:XX:XX"

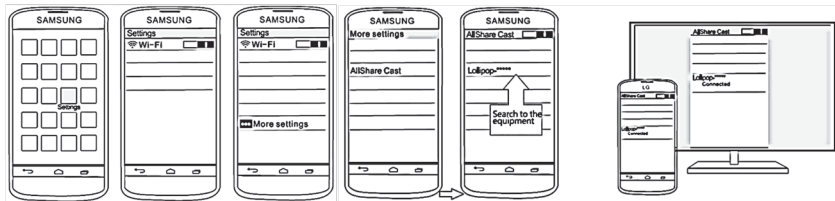

LG Nexus4

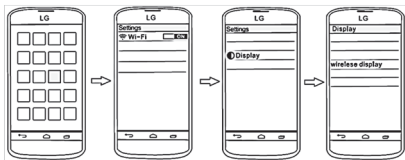

Sony Xperia Z

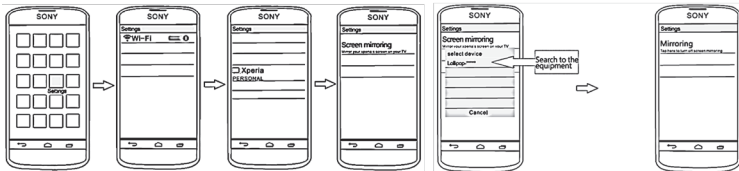

SPECIFICATIONS

Wifi-Standard	IEEE802.11 b/g/n
Video-formats	MPEG 1/2/4, FLV, MJPEG, H.264, WMV, MOV, AVI, DAT, ASF, MKV, RM, RMVB, TS, MPG, MPEG, VOB, 3GP, WEBM, ASF
Audio-formats	MP1, MP2, MP3, WMA, M4A, WAV, APE, AAC, OGG, OGA, FLAC
Picture-formats	JPEG, BMP, PNG, GIF
Input/Output ports	HDMIx1; Micro USBx2
Rated Voltage	5V 500mA DC
Power Consumption	About 1,0-2,5W

Dieses Produkt enthält Software, welche ganz oder teilweise als freie Software den Lizenzbedingungen der GNU General Public License, Version 2 (GPL) unterliegt.

Den Quellcode der Software erhalten Sie unter <http://www.pearl.de/support/> unter dortiger Eingabe der Artikelnummer; wir senden Ihnen auf Anforderung (gerne unter opensource@pearl.de) den SourceCode auch auf einem handelsüblichen Datenträger, dessen Herstellungskosten wir im Gegenzug geltend machen; den vollständigen Lizenztext ansehen Sie nachfolgend. Näheres, insbesondere auch dazu, warum es keine offizielle deutsche Übersetzung der Lizenzbedingungen gibt, erfahren Sie unter <http://www.gnu.org/licenses/gpl-2.0.html>. Da es sich um freie Software handelt, schließen die Entwickler dieser Software die Haftung, soweit gesetzlich zulässig, aus. Bitte beachten Sie, dass die Gewährleistung für die Hardware davon natürlich nicht betroffen ist und in vollem Umfang besteht. Weitere Fragen beantworten wir Ihnen gerne unter opensource@pearl.de.

GNU GENERAL PUBLIC LICENSE Version 2, June 1991

Copyright (C) 1989, 1991 Free Software Foundation, Inc. 51 Franklin Street, Fifth Floor, Boston, MA 02110-1301, USA

Everyone is permitted to copy and distribute verbatim copies of this license document, but changing it is not allowed.

PREAMBLE

The licenses for most software are designed to take away your freedom to share and change it. By contrast, the GNU General Public License is intended to guarantee your freedom to share and change free software--to make sure the software is free for all its users. This General Public License applies to most of the Free Software Foundation's software and to any other program whose authors commit to using it. (Some other Free Software Foundation software is covered by the GNU Lesser General Public License instead.) You can apply it to your programs, too.

When we speak of free software, we are referring to freedom, not price. Our General Public Licenses are designed to make sure that you have the freedom to distribute copies of free software (and charge for this service if you wish), that you receive source code or can get it if you want it, that you can change the software or use pieces of it in new programs; and that you know you can do these things.

To protect your rights, we need to make restrictions that forbid anyone to deny you these rights or to ask you to surrender the rights. These restrictions translate to certain responsibilities for you if you distribute copies of the software, or if you modify it.

For example, if you distribute copies of such a program, whether gratis or for a fee, you must give the recipients all the rights that you have. You must make sure that they, too, receive or can get the source code. And you must show them these terms so they know their rights.

We protect your rights with two steps: (1) copyright the software, and (2) offer you this license which gives you legal permission to copy, distribute and/or modify the software.

Also, for each author's protection and ours, we want to make certain that everyone understands that there is no warranty for this free software. If the software is modified by someone else and passed on, we want its recipients to know that what they have is not the original, so that any problems introduced by others will not reflect on the original authors' reputations.

Finally, any free program is threatened constantly by software patents. We wish to avoid the danger that redistributors of a free program will individually obtain patent licenses, in effect making the program proprietary. To prevent this, we have made it clear that any patent must be licensed for everyone's free use or not licensed at all. The precise terms and conditions for copying, distribution and modification follow.

TERMS AND CONDITIONS FOR COPYING, DISTRIBUTION AND MODIFICATION

1. This License applies to any program or other work which contains a notice placed by the copyright holder saying it may be distributed under the terms of this

General Public License. The „Program“, below, refers to any such program or work, and a „work based on the Program“ means either the Program or any derivative work under copyright law: that is to say, a work containing the Program or a portion of it, either verbatim or with modifications and/or translated into another language. (Hereinafter, translation is included without limitation in the term „modification“.) Each licensee is addressed as „you“.

Activities other than copying, distribution and modification are not covered by this License; they are outside its scope. The act of running the Program is not restricted, and the output from the Program is covered only if its contents constitute a work based on the Program (independent of having been made by running the Program). Whether that is true depends on what the Program does.

2. You may copy and distribute verbatim copies of the Program's source code as you receive it, in any medium, provided that you conspicuously and appropriately publish on each copy an appropriate copyright notice and disclaimer of warranty; keep intact all the notices

that refer to this License and to the absence of any warranty; and give any other recipients of the Program a copy of this License along with the Program. You may charge a fee for the physical act of transferring a copy, and you may at your option offer warranty protection in exchange for a fee.

3. You may modify your copy or copies of the Program or any portion of it, thus forming a work based on the Program, and copy and distribute such modifications or work under the terms of Section 1 above, provided that you also meet all of these conditions:
 - You must cause the modified files to carry prominent notices stating that you changed the files and the date of any change.
 - You must cause any work that you distribute or publish, that in whole or in part contains or is derived from the Program or any part thereof, to be licensed as a whole at no charge to all third parties under the terms of this License.
 - If the modified program normally reads commands interactively when run, you must

cause it, when started running for such interactive use in the most ordinary way, to print or display an announcement including an appropriate copyright notice and a notice that there is no warranty (or else, saying that you provide a warranty) and that users may redistribute the program under these conditions, and telling the user how to view a copy of this License.(Exception: if the Program itself is interactive but does not normally print such an announcement, your work based on the Program is not required to print an announcement.)

These requirements apply to the modified work as a whole.If identifiable sections of that work are not derived from the Program, and can be reasonably considered independent and separate works in themselves, then this License, and its terms, do not apply to those sections when you distribute them as separate works.But when you distribute the same sections as part of a whole which is a work based on the Program, the distribution of the whole must be on the terms of this License, whose permissions for

other licensees extend to the entire whole, and thus to each and every part regardless of who wrote it. Thus, it is not the intent of this section to claim rights or contest your rights to work written entirely by you; rather, the intent is to exercise the right to control the distribution of derivative or collective works based on the Program.

In addition, mere aggregation of another work not based on the Program with the Program (or with a work based on the Program) on a volume of a storage or distribution medium does not bring the other work under the scope of this License.

4. You may copy and distribute the Program (or a work based on it, under Section 2) in object code or executable form under the terms of Sections 1 and 2 above provided that you also do one of the following:
 - Accompany it with the complete corresponding machine-readable source code, which must be distributed under the terms of Sections 1 and 2 above on a medium customarily used for software interchange; or,

- Accompany it with a written offer, valid for at least three years, to give any third party, for a charge no more than your cost of physically performing source distribution, a complete machine-readable copy of the corresponding source code, to be distributed under the terms of Sections 1 and 2 above on a medium customarily used for software interchange; or,
- Accompany it with the information you received as to the offer to distribute corresponding source code. (This alternative is allowed only for noncommercial distribution and only if you received the program in object code or executable form with such an offer, in accord with Subsection b above.)

The source code for a work means the preferred form of the work for making modifications to it. For an executable work, complete source code means all the source code for all modules it contains, plus any associated interface definition files, plus the scripts used to control compilation and installation of the executable. However, as a special

exception, the source code distributed need not include anything that is normally distributed (in either source or binary form) with the major components (compiler, kernel, and so on) of the operating system on which the executable runs, unless that component itself accompanies the executable.

If distribution of executable or object code is made by offering access to copy from a designated place, then offering equivalent access to copy the source code from the same place counts as distribution of the source code, even though third parties are not compelled to copy the source along with the object code.

5. You may not copy, modify, sublicense, or distribute the Program except as expressly provided under this License. Any attempt otherwise to copy, modify, sublicense or distribute the Program is void, and will automatically terminate your rights under this License. However, parties who have received copies, or rights, from you under this License will not have their licenses terminated so long as such parties re-

main in full compliance.

6. You are not required to accept this License, since you have not signed it. However, nothing else grants you permission to modify or distribute the Program or its derivative works. These actions are prohibited by law if you do not accept this License. Therefore, by modifying or distributing the Program (or any work based on the Program), you indicate your acceptance of this License to do so, and all its terms and conditions for copying, distributing or modifying the Program or works based on it.
7. Each time you redistribute the Program (or any work based on the Program), the recipient automatically receives a license from the original licensor to copy, distribute or modify the Program subject to these terms and conditions. You may not impose any further restrictions on the recipients' exercise of the rights granted herein. You are not responsible for enforcing compliance by third parties to this License.
8. If, as a consequence of a court judgment or allegation of patent infringement or for any other reason (not limited to patent issues), conditions are imposed on you (whether by court order, agreement or otherwise) that contradict the conditions of this License, they do not excuse you from the conditions of this License. If you cannot distribute so as to satisfy simultaneously your obligations under this License and any other pertinent obligations, then as a consequence you may not distribute the Program at all. For example, if a patent license would not permit royalty-free redistribution of the Program by all those who receive copies directly or indirectly through you, then the only way you could satisfy both it and this License would be to refrain entirely from distribution of the Program. If any portion of this section is held invalid or unenforceable under any particular circumstance, the balance of the section is intended to apply and the section as a whole is intended to apply in other circumstances.

It is not the purpose of this section to induce you to infringe any patents or other property right claims

or to contest validity of any such claims; this section has the sole purpose of protecting the integrity of the free software distribution system, which is implemented by public license practices. Many people have made generous contributions to the wide range of software distributed through that system in reliance on consistent application of that system; it is up to the author/donor to decide if he or she is willing to distribute software through any other system and a licensee cannot impose that choice.

This section is intended to make thoroughly clear what is believed to be a consequence of the rest of this License.

9. If the distribution and/or use of the Program is restricted in certain countries either by patents or by copyrighted interfaces, the original copyright holder who places the Program under this License may add an explicit geographical distribution limitation excluding those countries, so that distribution is permitted only in or among countries not thus excluded. In such case, this License incorpo-

rates the limitation as if written in the body of this License.

10. The Free Software Foundation may publish revised and/or new versions of the General Public License from time to time. Such new versions will be similar in spirit to the present version, but may differ in detail to address new problems or concerns.

Each version is given a distinguishing version number. If the Program specifies a version number of this License which applies to it and „any later version“, you have the option of following the terms and conditions either of that version or of any later version published by the Free Software Foundation. If the Program does not specify a version number of this License, you may choose any version ever published by the Free Software Foundation.

11. If you wish to incorporate parts of the Program into other free programs whose distribution conditions are different, write to the author to ask for permission. For software which is copyrighted by the Free

Software Foundation, write to the Free Software Foundation; we sometimes make exceptions for this. Our decision will be guided by the two goals of preserving the free status of all derivatives of our free software and of promoting the sharing and reuse of software generally.

NO WARRANTY

12. BECAUSE THE PROGRAM IS LICENSED FREE OF CHARGE, THERE IS NO WARRANTY FOR THE PROGRAM, TO THE EXTENT PERMITTED BY APPLICABLE LAW. EXCEPT WHEN OTHERWISE STATED IN WRITING THE COPYRIGHT HOLDERS AND/OR OTHER PARTIES PROVIDE THE PROGRAM „AS IS“ WITHOUT WARRANTY OF ANY KIND, EITHER EXPRESSED OR IMPLIED, INCLUDING, BUT NOT LIMITED TO, THE IMPLIED WARRANTIES OF MERCHANTABILITY AND FITNESS FOR A PARTICULAR PURPOSE. THE ENTIRE RISK AS TO THE QUALITY AND PERFORMANCE OF THE PROGRAM IS WITH YOU. SHOULD THE PROGRAM PROVE DEFECTIVE, YOU ASSUME THE COST OF ALL NECESSARY SERVICING, REPAIR OR CORRECTION.
13. IN NO EVENT UNLESS REQUIRED BY APPLICABLE LAW OR AGREED TO IN WRITING WILL ANY COPYRIGHT HOLDER, OR ANY OTHER PARTY WHO MAY MODIFY AND/OR REDISTRIBUTE THE PROGRAM AS PERMITTED ABOVE, BE LIABLE TO

YOU FOR DAMAGES, INCLUDING ANY GENERAL, SPECIAL, INCIDENTAL OR CONSEQUENTIAL DAMAGES ARISING OUT OF THE USE OR INABILITY TO USE THE PROGRAM (INCLUDING BUT NOT LIMITED TO LOSS OF DATA OR DATA BEING RENDERED INACCURATE OR LOSSES SUSTAINED BY YOU OR THIRD PARTIES OR A FAILURE OF THE PROGRAM TO OPERATE WITH ANY OTHER PROGRAMS), EVEN IF SUCH HOLDER OR OTHER PARTY HAS BEEN ADVISED OF THE POSSIBILITY OF SUCH DAMAGES.

Importiert von:
PEARL.GmbH
PEARL-Straße 1-3
79426 Buggingen